

# Sponsorship Schedule

*Sponsor construction costs of a piece of a school, or sponsor the whole school!*

- |    |  |                 |
|----|--|-----------------|
| 1. | <b>A complete School:</b> 7 classrooms for Standards 1 to 7, a General Office and a Teacher's Room.<br>- the school named after you with the name engraved on a plaque mounted on an exterior wall at the school entrance. | <b>\$50,500</b> |
| 2. | <b>A complete Teacher's Residence Building</b> for 2 teacher families<br>- the building named after you with your name mounted on a plaque on an exterior wall   | <b>\$10,000</b> |
| 3. | <b>A 3-Classroom Building</b><br>- the building named after you with your name mounted on a plaque on an exterior wall   | <b>\$19,500</b> |
| 4. | <b>A 2-Classroom + Offices Building</b><br>- the building named after you with your name mounted on a plaque on an exterior wall   | <b>\$18,000</b> |
| 5. | <b>A Kitchen and Dining Building</b><br>- the building named after you with your name mounted on a plaque on an exterior wall  | <b>\$18,000</b> |
| 6. | <b>A 2-Classroom Building</b><br>- the building named after you with your name mounted on a plaque on an exterior wall   | <b>\$13,000</b> |
| 7. | <b>A Classroom</b><br>- the classroom named after you with your name mounted on a plaque on a wall inside the classroom  | <b>\$6,500</b>  |
| 8. | <b>A Teacher's Residence</b><br>- the residence named after you with your name mounted on a plaque on an exterior wall   | <b>\$5,000</b>  |

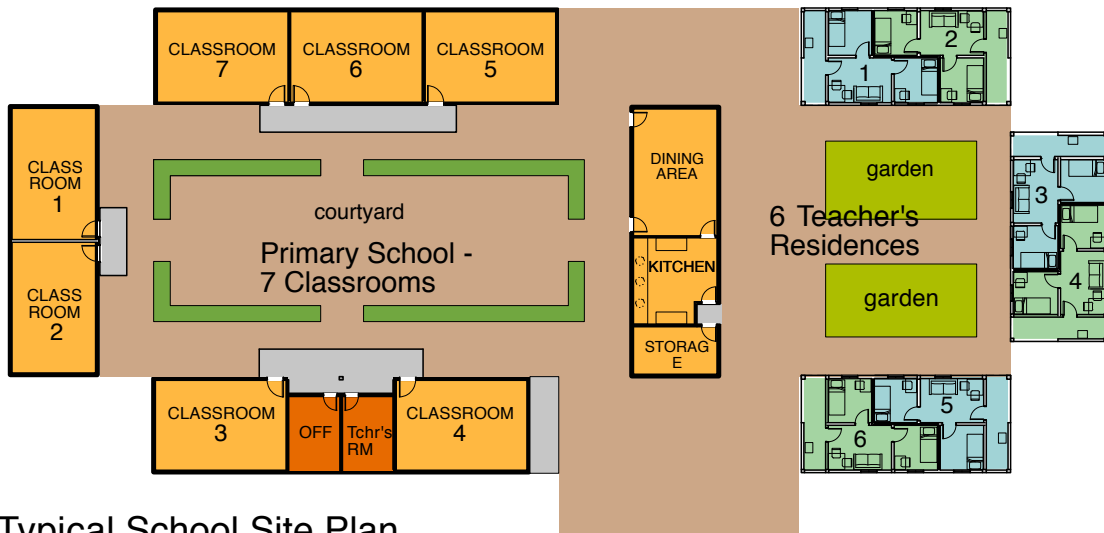

Typical School Site Plan  
Primary Schools for Africa Society